

# PG15 & 20 Series

Stainless Steel  
1.5 inch and 2 inch Dial Pressure Gauges

The PG15 & 20 Series stainless steel gauges were designed and developed for the demanding high-purity applications of the semiconductor industry. The multi-scale dial faced gauges offer a reliable and efficient way to monitor pressure locally. These durable measuring devices come in a variety of process connections, pressure ranges, and socket orientations.



## Features

Robust Stainless Steel Mechanical Linkage Assembly
Wide Pressure Range Offering
316L SS Gauges Welded in Oxygen-Free Chambers
Multi-Scale Dial

## Benefits

Accurate, precise, and repeatable performance
Supports variety of application needs
Meets rigid cleanliness and safety standards
Streamlines inventory and reduces stocking complexity

# Product Specifications

	PG15 (C15 and S15)	PG20 (C20 and S20)
<b>Product Specifications</b>		
Socket Orientation	Center Back or Stem Mounted	
Dial Size	1 ½"	2"
Pressure Unit	PSI, MPA, KPA	PSI, MPA, KPA, BAR, KG/CM <sup>2</sup>
Fitting Max Pressure Rating	8000 PSI for ¼" NPT, 4400 PSI for ¼" Face Seal (SM and SF), 750 PSI for 1.125" C-Seal (CS)	
Pressure Span	15 PSI (-15~0 PSIG or 0~15 PSIG) Min to 4000 PSI Max and not exceeding fitting pressure ratings	
Accuracy	3/2/3% or Class B	2/1/2% or Class A
Gauge Damping	DRY. USE NO OIL	
Pressure Cycle Usage	25-75% F.S.	
Helium Leak Check	< 4 x 10 <sup>-9</sup> inboard std. cc/sec	
Proof Pressure Rating	110% F.S.	
Burst Pressure Rating	400% of Max pressure rating and not exceeding fitting pressure ratings	
Operating (Ambient) Temperature	-40°F to 174°F (-40°C to 79°C)	
Media Temperature	Gas or Fluid, -40°C to 100°C	
Cleanliness	ASME B40.1 Level IV	
Wetted Material	316L Stainless Steel	
Wetted Surface Finish	< 32 Ra, excluding weld joints and threads	
Safety Relief	Unrestricted blow-out rubber plug on back	
Approximate Weight	~0.20 lbs (0.09 kg)	~0.23 lbs (0.10 kg)
<b>Materials of Construction</b>		
Case Material	300 series SS	
Bezel and Lens Material	Clear polycarbonate, snap on	Clear polycarbonate, screw on

C15 with 1/4" Face Seal, Female

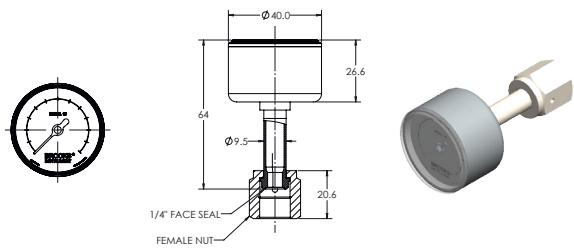

S15 with 1/4" Face Seal, Female

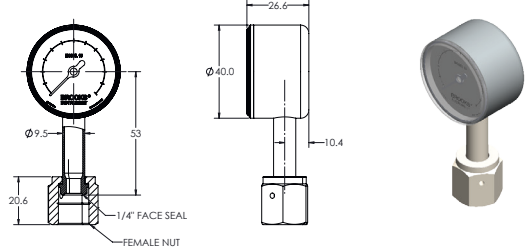

C15 with 1/4" Face Seal, Male

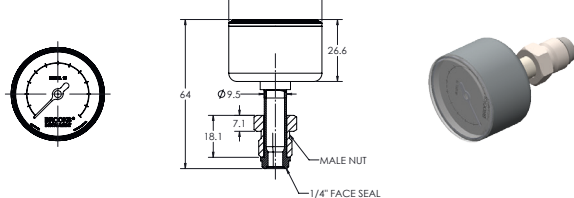

S15 with 1/4" Face Seal, Male

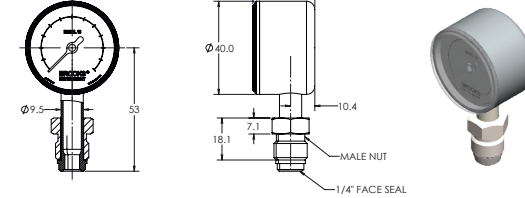

C15 with 1.125" C-Seal

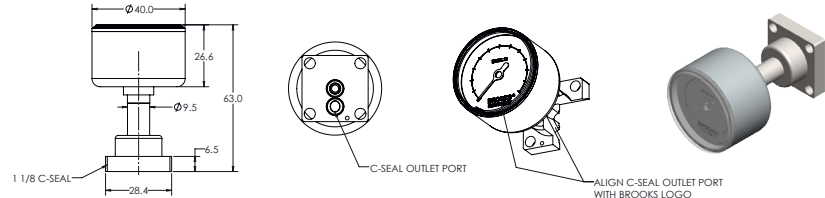

PG15

C20 with 1/4" NPT

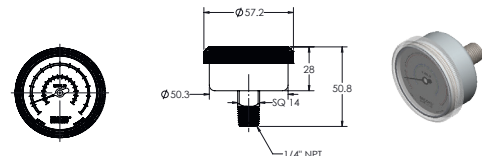

S20 with 1/4" NPT

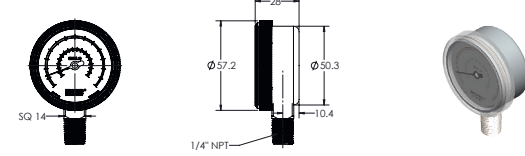

C20 with 1/4" Face Seal, Female

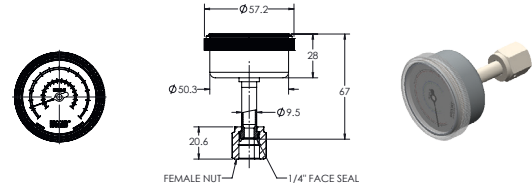

S20 with 1/4" Face Seal, Female

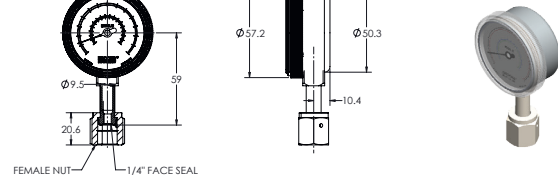

PG20

C20 with 1/4" Face Seal, Male

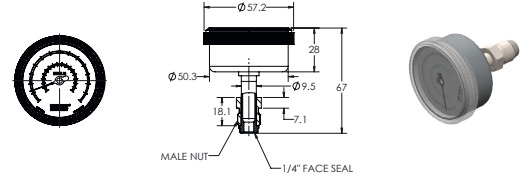

S20 with 1/4" Face Seal, Male

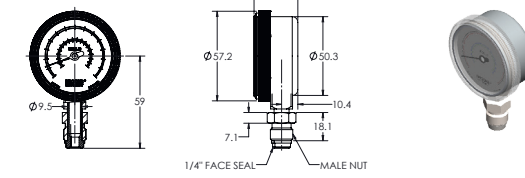

Code Description	Code Option	Option Description
I. Socket Orientation	C	Center Back Mounted
	S	Stem Mounted
II. Model/Series	15	1.5" Dial
	20	2" Dial
III. Pressure Range* *Use max scale PSI equivalent (See Pressure Unit Conversion Table for reference).	000	0 (2" dial & vacuum measurement only)
	015	15
	030	30
	060	60
	100	100
	160	160
	200	200
	300	300
	1K0	1000
	3K0	3000
	4K0	4000
IV. Pressure Unit	P	PSI
V. Vacuum	G	Non-Vacuum
	C	Vacuum
VI. Connection	SM	1/4" Face seal swivel male
	SF	1/4" Face seal swivel female
	NT	1/4" NPT male
	CS	1.125" C-Seal - Only 1.5" dial
VII. Dial Face Pressure Units	0	2" Dial: PSI + Kg/cm <sup>2</sup> + BAR + KPa or MPa 1.5" Dial: PSI + KPa or MPa

## Sample Model Code

I	II	III	IV	V	VI	VII	Description
S	20	100	P	G	SM	0	Stem Mount 2" Dial 0-100 PSIG 1/4" Face seal, Male

Min (PSI)	*Max (PSI)	Smallest PSI Graduation	Min (KPa)	Max (KPa)	Min (Kg/cm <sup>2</sup> )	Max (Kg/cm <sup>2</sup> )	Min (BAR)	Max (BAR)	Min (MPa)	Max (MPa)
-15	0	0.5	-101	0	-1	0	-1	0	-0.1	0
-15	15	1	-101	103	-1	1	-1	1	-0.1	0.1
-15	30	1	-101	207	-1	2	-1	2	-0.1	0.2
-15	60	2	-101	414	-1	4	-1	4	-0.1	0.4
-15	100	2	-101	690	-1	7	-1	7	-0.1	0.7
-15	160	5	-101	1103	-1	11	-1	11	-0.1	1.1
-15	200	5	-101	1379	-1	14	-1	14	-0.1	1.4
0	15	0.5	0	103	0	1	0	1	0.0	0.1
0	30	1	0	207	0	2	0	2	0	0.2
0	60	2	0	414	0	4	0	4	0	0.4
0	100	2	0	690	0	7	0	7	0	0.7
0	160	5	0	1103	0	11	0	11	0	1.1
0	200	5	0	1379	0	14	0	14	0	1.4
0	300	10	0	2069	0	21	0	21	0	2.1
0	1000	20	0	6895	0	70	0	69	0	6.9
0	3000	100	0	20685	0	211	0	207	0	20.7
0	4000	100	0	27580	0	281	0	276	0	27.6

**Pressure Unit Conversion Table (Based on Standard Ranges)**

Brooks is committed to assuring all of our customers receive the optimal solution for their application, along with outstanding service and support to back it up. We operate first class repair facilities located around the world to provide rapid response and support. Each location utilizes primary standard calibration equipment to ensure accuracy and reliability for repairs and recalibration and is certified by our local Weights and Measures Authorities and traceable to the relevant International Standards.

Visit [www.BrooksInstrument.com](http://www.BrooksInstrument.com) to locate the service location nearest to you.

## START-UP SERVICE AND IN-SITU CALIBRATION

Brooks Instrument can provide start-up service prior to operation when required. For some process applications, where ISO-9001 Quality Certification is important, it is mandatory to verify and/or (re)calibrate the products periodically. In many cases this service can be provided under in-situ conditions, and the results will be traceable to the relevant international quality standards.

## CUSTOMER SEMINARS AND TRAINING

Brooks Instrument can provide customer seminars and dedicated training to engineers, end users, and maintenance persons. Please contact your nearest sales representative for more details. Due to Brooks Instrument's commitment to continuous improvement of our products, all specifications are subject to change without notice.

## TRADEMARKS

Brooks .....Brooks Instrument, LLC

All other trademarks are the property of their respective owners.



Data-Sheet-PG15-PG20-EN/2025-10

## Global Headquarters

### Brooks Instrument

407 West Vine Street  
Hatfield, PA  
19440-0903 USA

Toll-Free (USA): 888-554-FLOW  
T: 215-362-3500

[BrooksAM@BrooksInstrument.com](mailto:BrooksAM@BrooksInstrument.com)

A list of all Brooks Instrument locations and contact details can be found at [www.BrooksInstrument.com](http://www.BrooksInstrument.com)

©Copyright 2025 Brooks Instrument, LLC All rights reserved. Printed in U.S.A.

**BROOKS**<sup>®</sup>  
INSTRUMENT

*Beyond Measure*